



GENUINE PARTS

INSTALLATION INSTRUCTIONS

DESCRIPTION: Rear Spoiler
APPLICATION: Versa Sedan (2012)
PART NUMBER: K6030 3ANxx (xx Designates color)

KIT CONTENTS:

| Item | Qty. | Part Description | Service Part Number |
|---------|------|--|---|
| A | 1 | Rear Spoiler | --- |
| B | 2 | Nut - M6 | --- |
| C | 1 | Installation Instructions Replacement Template | --- |
| D or D' | 1 | Template - CTR | There are 2 type of template. Either "D+E+F" or "D'+E'+F'" is in the kit. |
| E or E' | 1 | Template - RH | |
| F or F' | 1 | Template - LH | |
| G | 1 | Torsion Bar - LH | 999J1 4YTB1 |
| H | 1 | Torsion Bar - RH | 999J1 4YTB0 |



A



B



C

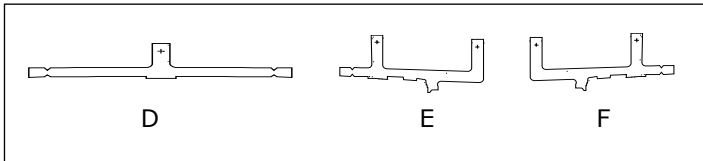

D

E

F

or

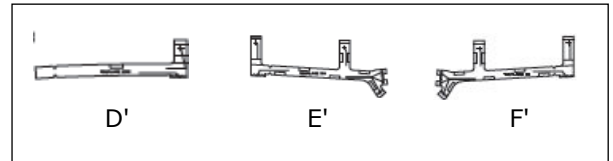

D'

E'

F'



G



H

TOOLS REQUIRED:

- 3mm (1/8"), 5mm (13/64"), 8mm (5/16"), 10mm (25/64") Drill bit
- Deep socket & driver 10 mm (25/64")
- Center punch/Awl
- Drop cloth
- Clean, lint-free wiping cloth
- Air compressor & blow gun
- 1/2" thick spacer block
- Torque wrench
- Deburring tool
- Rust preventative(P/N 999MP-9G001P)
- 90% or greater alcohol
- 12" long flat-head screwdriver
- knife
- Clean shop rags
- Clip remover
- Drill
- Masking tape
- Small ruler
- Marker

PRE-INSTALLATION CAUTIONS/NOTES:

- Dealer Installation Recommended. Instructions may refer to Service Manual.

CAUTION

- Install the Rear spoiler when the ambient temperature is above 60°F (15°C).
- Do not wash or expose the vehicle to a wet environment for 24 hours after installing the Rear Spoiler.

INSTALLATION PROCEDURE:

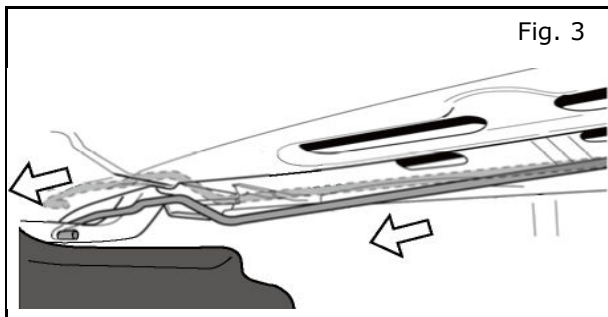
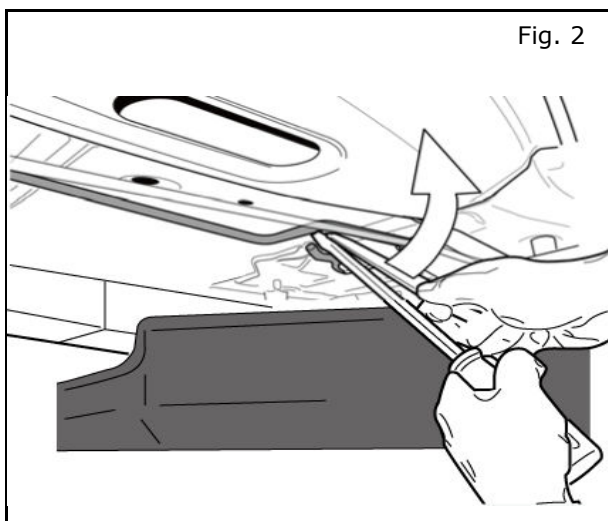
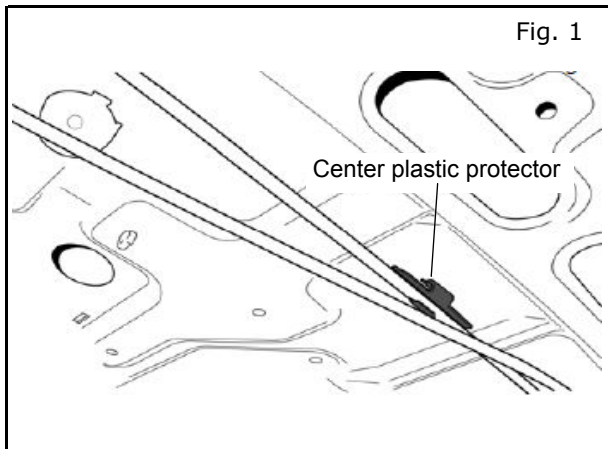

- 1) Apply Parking Brake.
- 2) Make sure shift lever is engaged in "P" position.
- 3) Fully open trunk lid. Support the trunk lid to prevent it from closing.

CAUTION

Trunk lid is heavy and will fall rapidly if not properly supported.

- 4) Remove and retain center plastic protector. See Fig.1.
- 5) Wrap 12" flat screwdriver with rags as shown to prevent torsion bar from slipping. See Fig.2.
- 6) Insert screwdriver and spacer on passenger side as shown in Fig.2. Pull up on screwdriver until torsion bar-LH end clears bracket. Pull torsion bar-LH rearward to release from bracket.

CAUTION

Reaction force of the torsion bar is big. Please work with care till release torsion bar from bracket.

- 7) Push opposite end of torsion bar-LH outboard to remove from deck lid hinge hold. See Fig.3.
- 8) To install Torsion Bar-LH(G), reverse step 6 and 7 above for torsion bar-Lh.
- 9) Repeat steps 6, 7 and 8 for driver's side to install Torsion Bar-RH(H)
- 10) Install center plastic protector removed in step 4. See Fig.1.
- 11) Open and close trunk lid to check operation of torsion bars. Ensure nothing is binding.

INSTALLATION PROCEDURE:

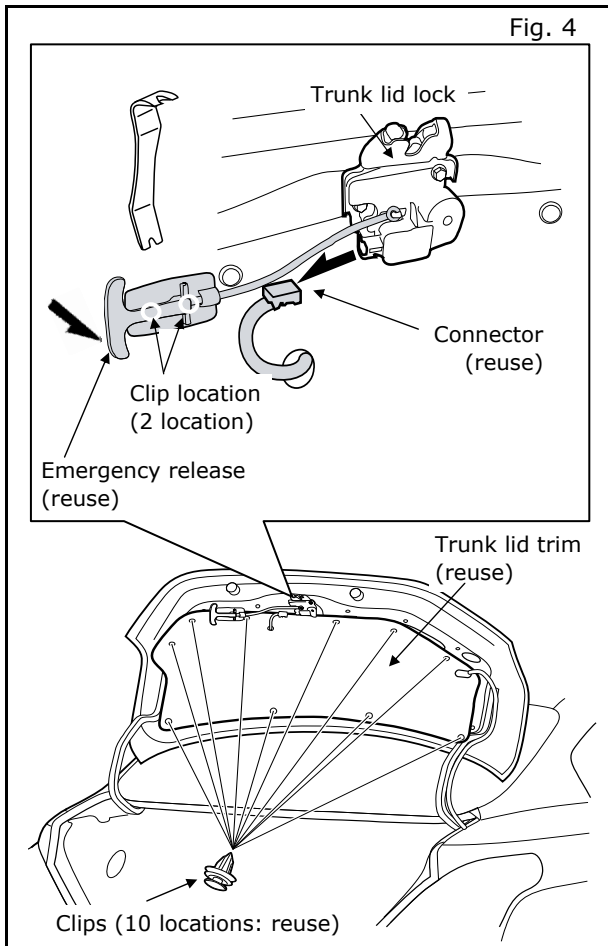

12) Open trunk lid.

NOTE:

If there is no trunk lid trim, skip steps 13), 14), 15) and go to step 16).

13) Remove Connector from Trunk lid lock. and remove Emergency release using clip remover. See Fig.4.

14) Remove inner trim clips from trunk lid using clip remover. (10 locations; reuse) See Fig.4.

15) Remove trunk lid trim.

NOTE:

- **Removed vehicle parts will be reused. Be careful not to lose.**
- **Service part number of Emergency release handle holder is 84694 7Y000. If this part is damaged in step 13) order this part number.**

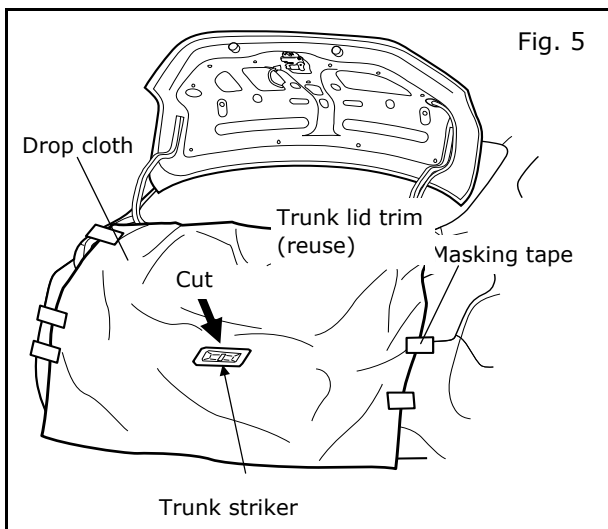

16) Affix drop cloth using masking tape to protect trunk area. See Fig.5.

NOTE:

Be sure to cover the striker with the drop cloth.

17) Cut the drop cloth to watch the trunk striker.

18) Close trunk lid.

INSTALLATION PROCEDURE: In case of Template D, E and F

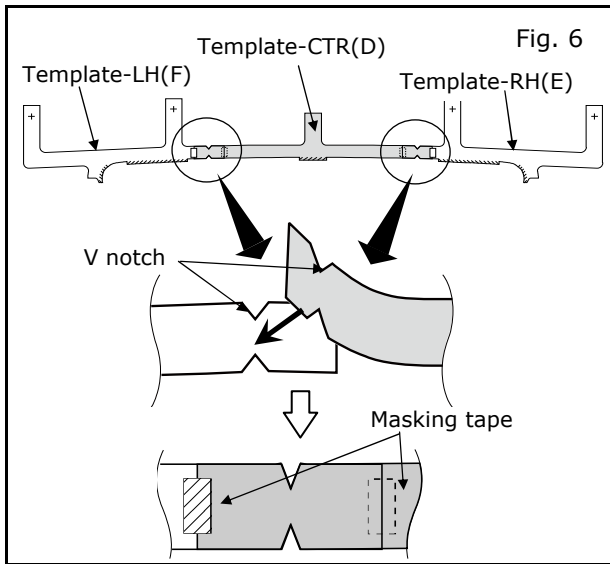

NOTE:

Following steps 19) through 21) indicate the procedure for template D, E and F. If template D', E' and F' are included, skip steps 19) through 22) and go to step 23).

- 19) Align V notch on Template-LH(F)/RH(E) with V notch on Template-CTR(D). Fix each with masking tape. See Fig.6.

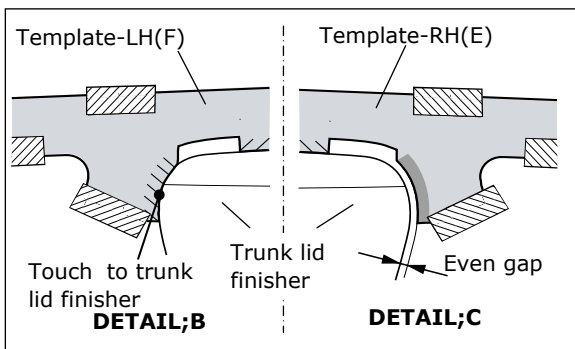
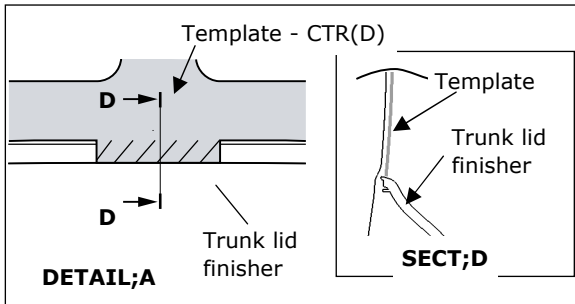
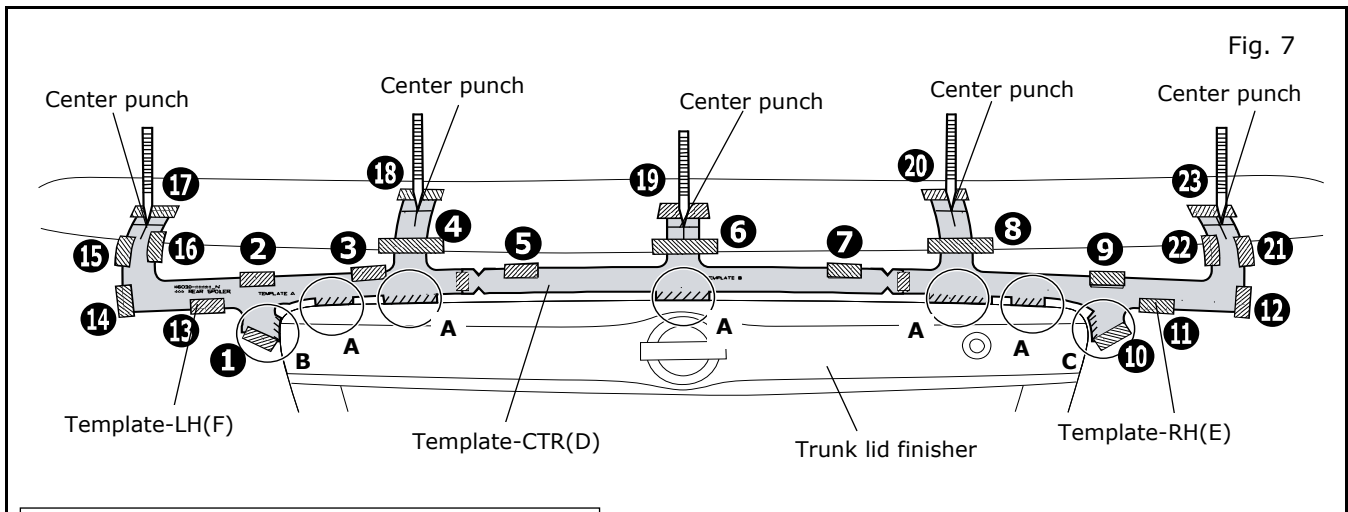

- 20) Align templates to trunk lid finisher and apply masking tape in sequence 1 to 23 to hold templates in place. See Fig.7.

NOTE:

- Template should touch trunk lid finisher at left side only. See Detail;B and C.
- If template is not in correct position, remove and realign.
- Templates should not have any wrinkles and should not have any gap between templates and trunk lid.

- 21) Mark hole position using center punch (5 location). Remove masking tape and templates. See Fig.7.

- 22) Go to step 27).

INSTALLATION PROCEDURE: In case of Template D', E' and F'

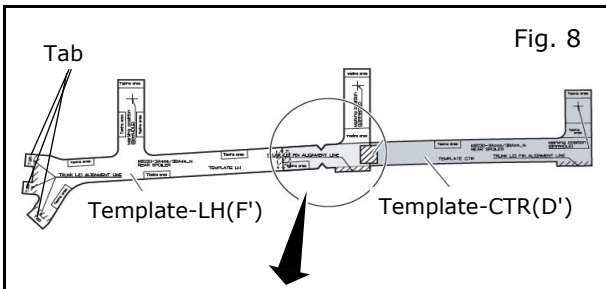

NOTE:

Following steps 23) through 26) indicate the procedure of template D', E' and F'.

- 23) Align V notch on Template-LH(F') with V notch on Template-CTR(D'). Fix each with masking tape. See Fig. 8.

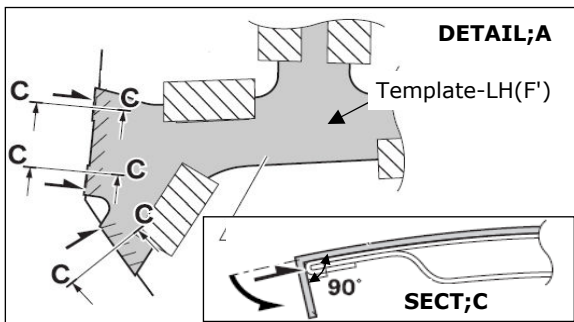
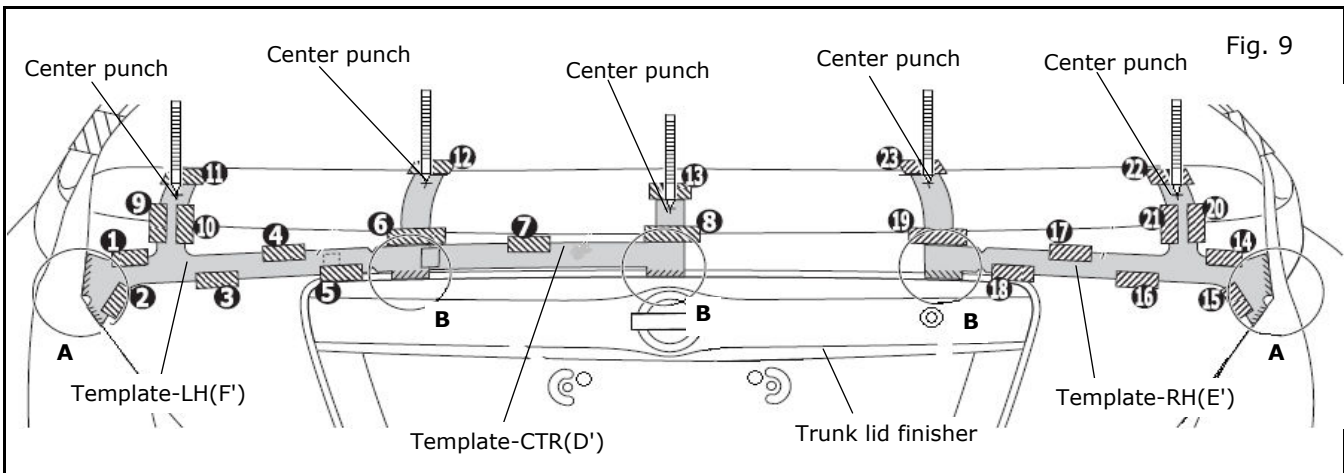
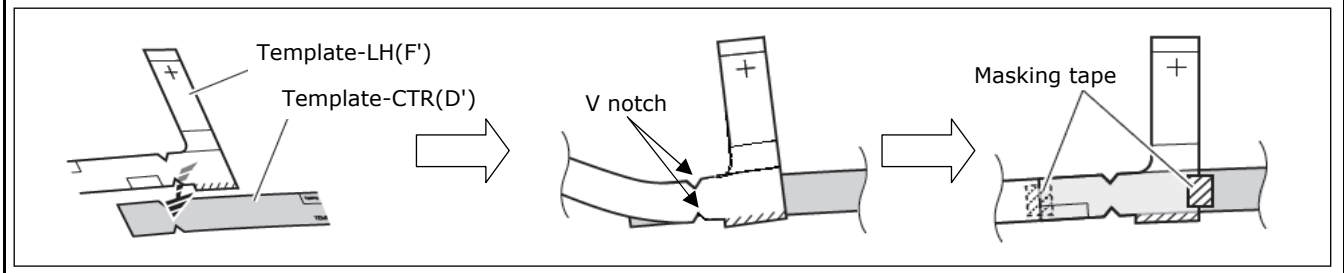

- 24) Fold tabs of F' and align template F' to left side edge of trunk lid panel. Apply masking tape in sequence 1 to 13 to hold template in place. See Fig.9.

- 25) Fold tabs of E' and align template E' to right side edge of trunk lid panel. Apply masking tape in sequence 14 to 23 to hold template in place. See Fig.9.

NOTE:

- **Make sure if tabs touches to trunk panel edge. See DETAIL;A, SECT;C.**
- **If template is not in correct position, remove and realign.**
- **Templates should not have any wrinkles and should not have any gap between templates and trunk lid panel.**

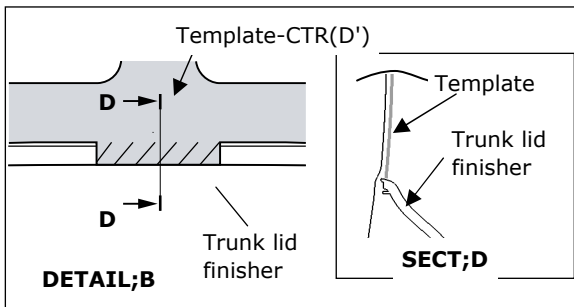

- 26) Mark hole position with center punch (5 location). Remove masking tape and templates.

INSTALLATION PROCEDURE:

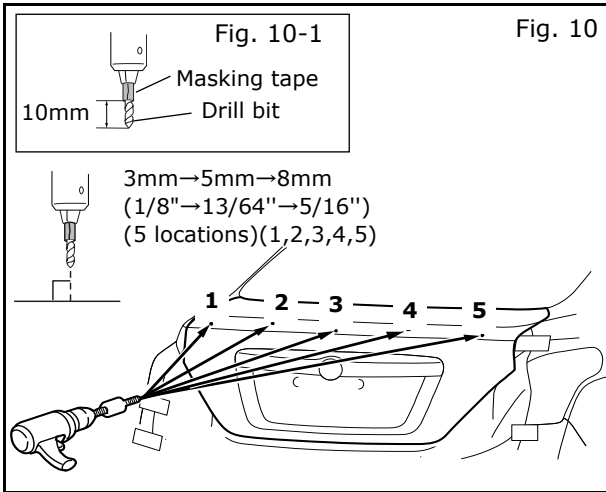

- 27) Wrap masking tape around 3mm (1/8"), 5mm (13/64"), 8mm (5/16") and 10mm (25/64") drill bits, approximately 10mm from the tip. See Fig.10-1.
- 28) Drill 3mm (1/8") → 5mm (13/64") → 8mm (5/16") holes at 5 marked locations(1,2,3,4,5) on trunk lid. See Fig.10.

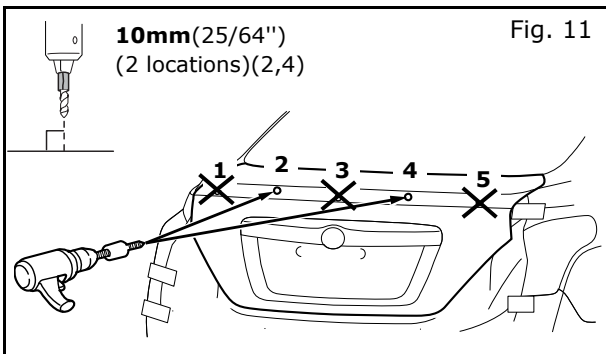

- 29) Drill 10mm(25/64") hole at 2 marked locations(2,4) on trunk lid. See Fig.11.
- 30) Remove any sharp edges from drilled holes using debur tool.

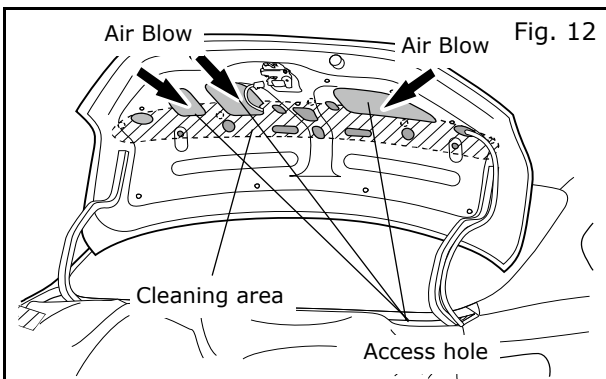

- 31) Open trunk lid.
- 32) Remove metal shavings from inside trunk lid with air compressor and blow gun.
- 33) Apply rust preventative (P/N 999MP 9G001P) to drilled holes. Let area dry thoroughly. See Fig.12.

CAUTION

Failure to apply rust preventative will result in red rust.

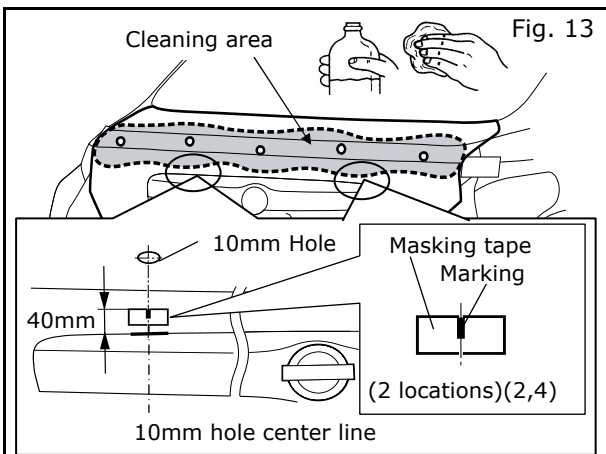

- 34) Close trunk lid.
- 35) Using clean, lint free cloth and 90% or greater alcohol, wipe any dirt and oil from mounting surface. Let area dry thoroughly.
- 36) Apply masking tape so that a mark can be made on the tape at 40mm above trunk lid finisher. Tape should be on center with 10mm hole. See Fig.13.

INSTALLATION PROCEDURE:

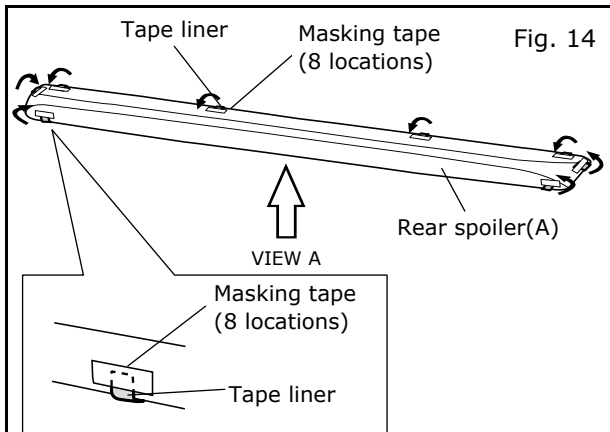

- 37) Fold tape liner pull tabs onto rear spoiler(A) surface and secure with masking tape to ensure that tape liner is accessible. See Fig. 14.

NOTE:

No tape should be exposed when wrapping and taping the liner pull tabs down.

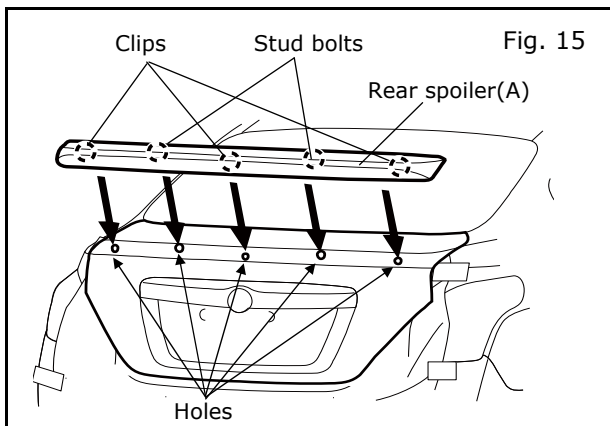
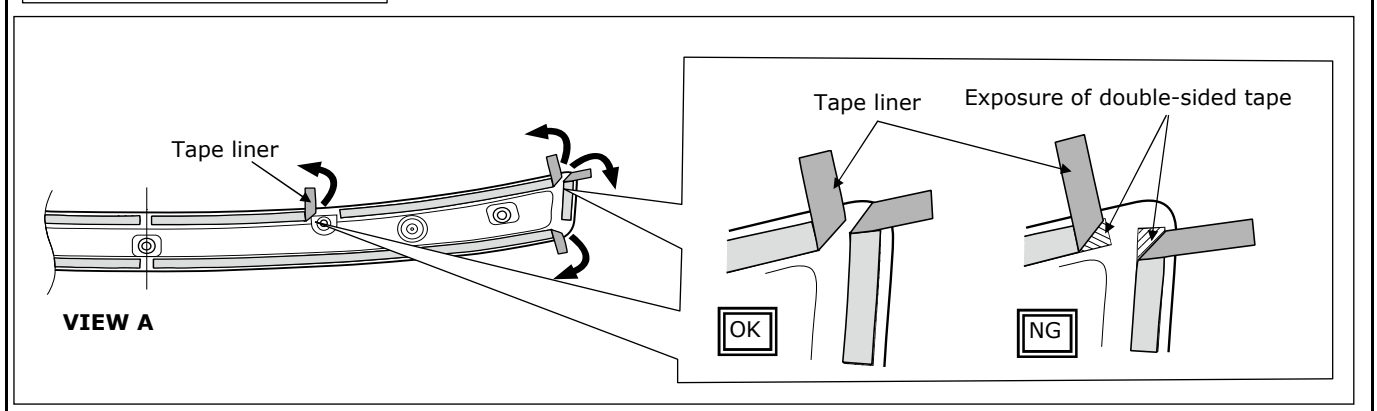

- 38) Align rear spoiler bolts and clips to drilled holes in trunk lid. See Fig.15.
- 39) Fully insert each clip on backside of Rear spoiler(A) into each hole until you hear the click sound. See Fig. 15.

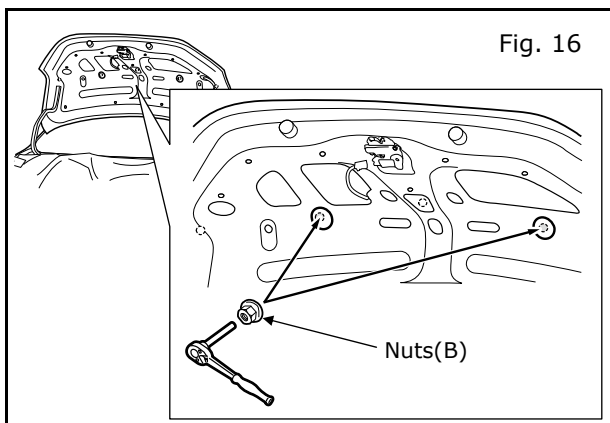

- 40) Open trunk lid.
- 41) Loosely install nuts(B) on stud bolt. See Fig.16.
- 42) Close trunk lid.

INSTALLATION PROCEDURE:

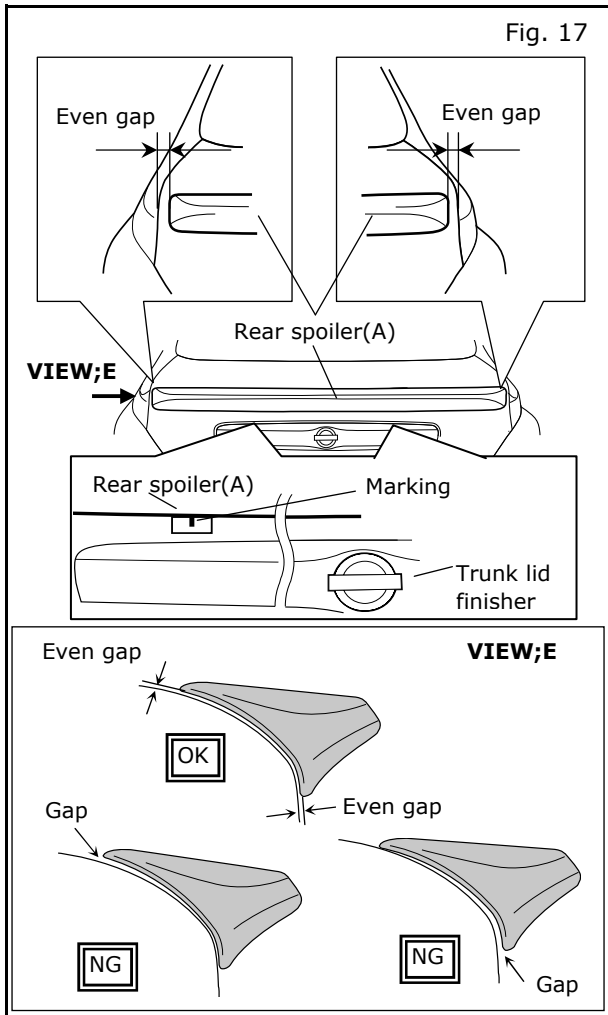

- 43) Check gap on RH and LH side and slide spoiler to right or left to achieve even gap on both sides. See Fig.17.
- 44) Align bottom edge of rear spoiler to top edge of marking. See Fig.17.

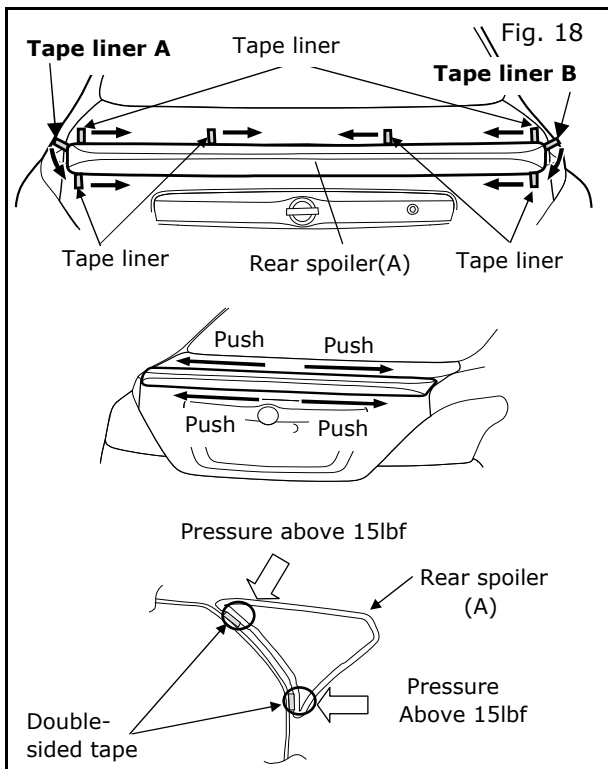

- 45) Remove tape liner A, B and firmly apply 15lbf pressure 3 times at tape location. See Fig.18.
- 46) Remove all tape liners and firmly apply 15lbf pressure 3 times at tape location while maintaining alignment with masking tape. See Fig. 18.

NOTE:
Use a roller or hands to apply minimum 15lbf of pressure along length of tape (starting at center of part and working outward).

INSTALLATION PROCEDURE:

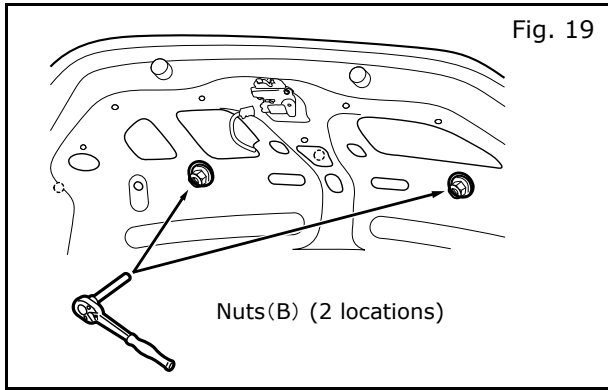

- 47) Open trunk lid.
- 48) Tighten nuts(B) on stud bolt (2 locations). See Fig.19.

NOTE:

Do not over tighten nuts. Reference tightening torque: 43.9 - 65.8 lbf·in (4.96 - 7.44 N·m)

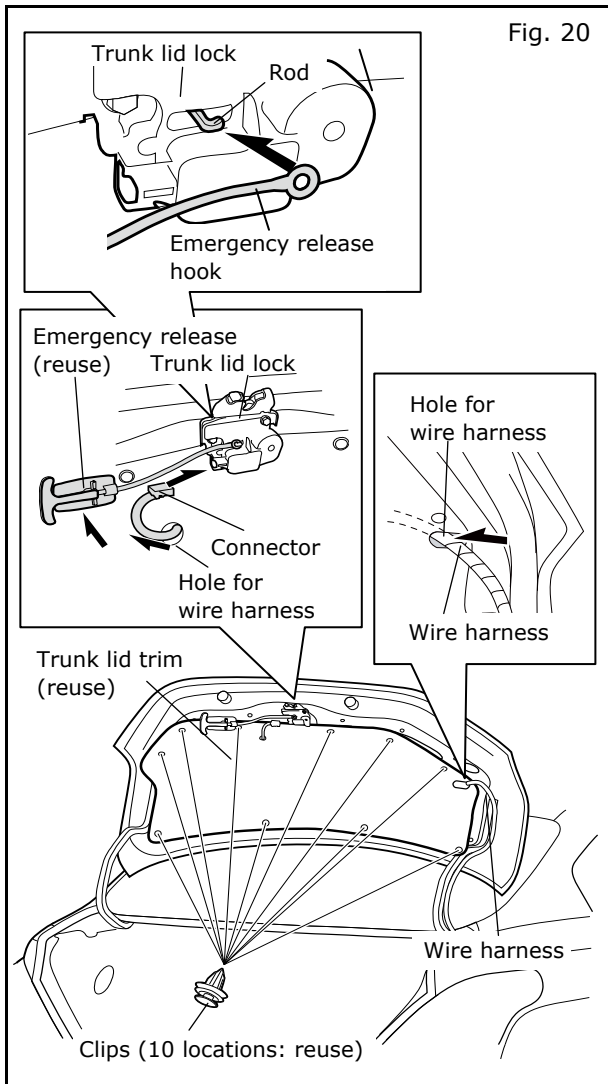

- 49) Reinstall all parts that were labeled as reuse using reverse of removal process. See Fig.20.
- 50) Close trunk lid.
- 51) Remove masking tape and drop cloth.

INSTALLATION PROCEDURE:

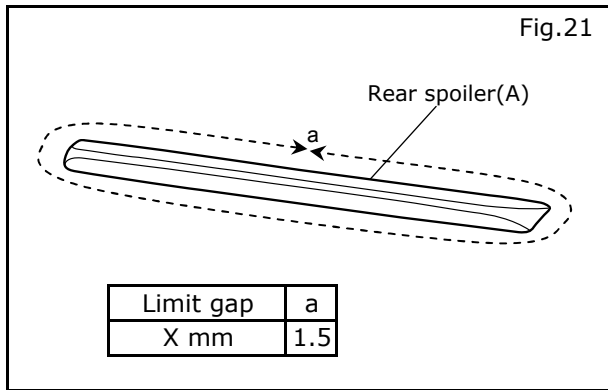

ACCESSORY CHECK:

- Please check that installation has no problem.
- Check gap. See Fig. 21.

REINSTALLATION OF REMOVED PARTS

- Re-install all removed vehicle parts. Refer to the vehicle service manual for more details.
- Clean trunk opening of vehicle.

FINAL INSPECTION:

- Verify re-installed trim parts for proper flush fit
- Verify all clips are fully engaged and locked.
- Verify re-installed trim parts are free from cracks, scratches or stress marks.

VEHICLE CHECK

- Remove all tools from vehicle.